

WT23L-F430

Photoelectric proximity switch



Scanning distance
 50 ... 800 mm
 Photoelectric proximity switch

- Very small and visible light spot
- Precise background suppression
- Laser class 1

Maßbild

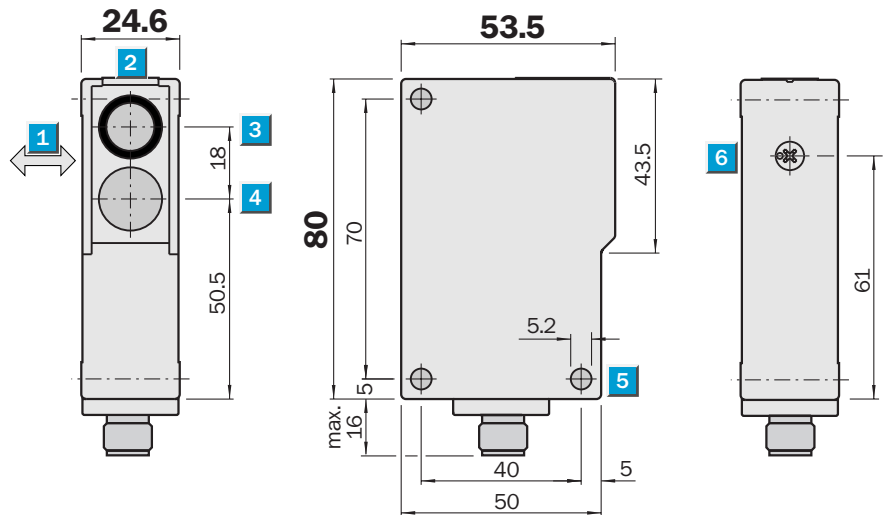

Adjustments possible

WT23L-F430

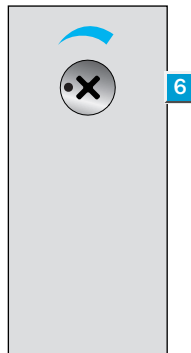

- 1 Standard direction of the material being scanned
- 2 LED indicator; power on and status of received light beam
- 3 Optical axis, sender
- 4 Optical axis, receiver
- 5 Mounting hole \varnothing 5.2 mm
- 6 Adjustment of scanning distance: Poti

Connection type

WT23L-F430

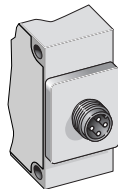

4-pin, M12

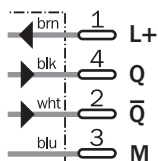

WT23L-F430 Laser Photoelectric proximity switch, background suppression – DC

Technical data		WT23L-	F430									
Scanning distance typ. max.	50 ... 800 mm											
Operating distance	100 ... 800 mm											
Adjustment of operating distance	Potentiometer											
Light source¹⁾, light type	LED Laser, red light											
Light spot diameter	Approx. 2 mm at 400 mm distance											
Supply voltage V_s	10 ... 30 V DC ²⁾											
Ripple ³⁾	$\leq 5 V_{pp}$											
Current consumption ⁴⁾	≤ 35 mA											
Switching outputs	PNP, antivalent											
Output current I_A max.	100 mA											
Response time ⁵⁾	25 ms											
Max. switching frequency ⁶⁾	50 Hz											
Connection type	Connector, M12, 4-pin											
VDE protection class⁷⁾	<input type="checkbox"/>											
Laser class	1 (EN 60 825-1)											
Circuit protection⁸⁾	A, B, C											
Enclosure rating	IP 65											
Ambient temperature	Operation -10 °C ... +45 °C Storage -10 °C ... +75 °C											
Weight	Approx. 100 g											
Housing material	ABS											

¹⁾ Average service life 50,000 h at $T_A = +25$ °C

²⁾ Limit values

³⁾ May not exceed or fall short of V_s tolerances

⁴⁾ Without load

⁵⁾ Signal transit time with resistive load

⁶⁾ With light/dark ratio 1:1

⁷⁾ Reference voltage 50 V DC

⁸⁾ A = V_s connection reverse-polarity protected

B = Output Q and \bar{Q} short-circuit protected

C = Interference pulse suppression

Scanning distance

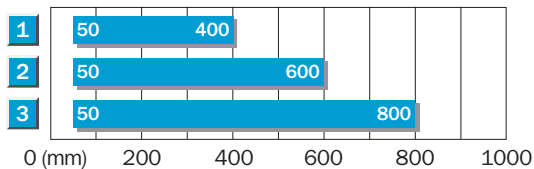

1	Scanning distance on black, 6% remission
2	Scanning distance on grey, 18% remission
3	Scanning distance on white, 90% remission

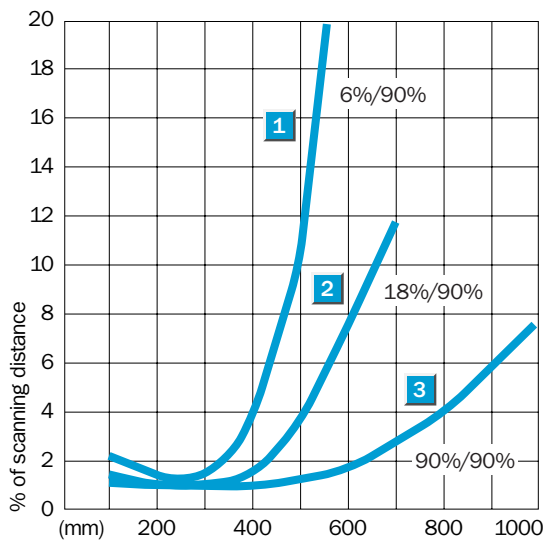

Order information

Type	Order no.
WT23L-F430	1045643

Great Britain

Phone +44 (0)1727 83 11 21
E-Mail info@sick.co.uk

USA

Phone +1(952) 941-6780
tollfree +1-800-325-7425
E-Mail info@sickusa.com

Australia

Phone +61 3 9497 4100
tollfree +1800 33 48 02
E-Mail sales@sick.com.au

More representatives and agencies in all major industrial nations at www.sick.com

SICK
Sensor Intelligence.