

# Safety interlocks

## i14 Lock



The i14 Lock is a safety locking device with an actuator lock that can prevent the machine guard from opening until the release mechanism is activated. This device is available with either 2 forced opening- normally closed contacts (NC) and with 1 signaling, normally open contact (NO), or with 3 forced opening-normally closed contacts (NC). The i14 Lock head can be turned 180° and provides two actuating directions. With the i14 Lock M... safety interlock (with mechanical locking), the guard can be open only by applying voltage to the coil. This device is an ideal solution for

machinery with a long stopping time, when premature interruption of the machine could cause damage to personnel or tools.

The locking mechanism can tolerate holding forces up to 1200 N. The auxiliary manual release mechanism (3-way) releases the guard in the event of general failure or of a power interruption.

The LED monitor, located on the housing, provides a visual assessment of the coil conditions.

## Drawings

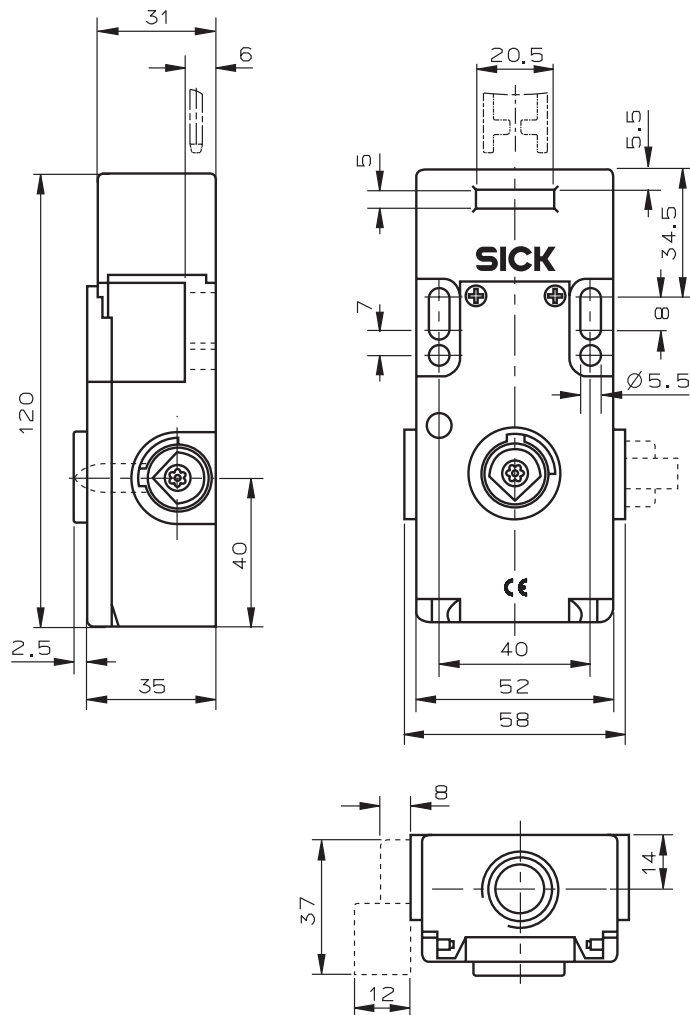

## Technical specifications

	<b>i14 Lock</b>
Housing material	glass-reinforced plastic
Environmental protection to IEC 60 529	IP 65
Mechanical service life	10 <sup>6</sup> switching operations
Ambient temperature	-10...60° C
Mounting position	optional
Connection type	M 20
Approach speed (max.)	160 mm/s
Actuating force (max.)	12 N
Retaining force in locked condition	1200 N
Contact elements positively guided NC/NO contacts	2/1 or 3/0
Utilization category to IEC 60 947-5-1	AC 15/AC: 2 A (250 V), 5 A (100 V) DC 13 DC: 0.5 A (250 V), 2 A (24 V)
Switching voltage (min.)	5 V
Switching current (min.) at 5 V DC	5 mA
Wire cross-section	1 X 1.5 mm <sup>2</sup>
Short-circuit protection	slow 10 A
Solenoid operating voltage	24 V DC, 110 V AC, 230 V AC
On time	100%
Power consumption	typical 7 W
Certifications	CE, cULus

**Switching elements**

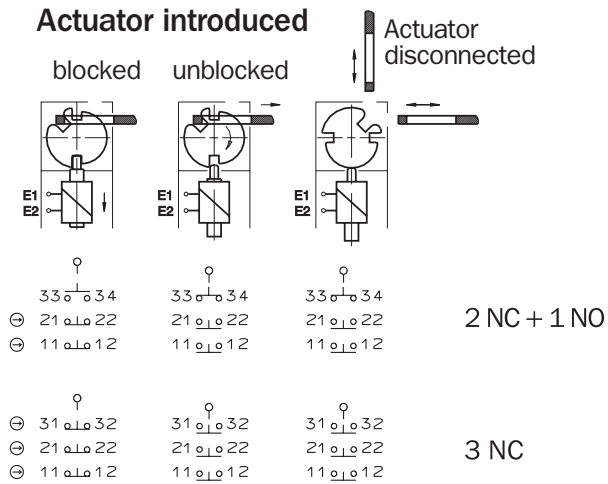

**SOLENOID OPERATING VOLTAGE**

24 V DC - 15...+10%

110 V AC - 15...+10%

230 V AC - 15...+10%

**Installation notes**

The safety switch and actuator must be assembled for installation purposes. The actuator must be permanently secured to the safety device such that it can no be detached, e.g., with unscrewable screws, rivets or welding. The safety switch should not be used as a mechanical stop plate.

**LED**

The safety device is open, the solenoid is activated.

**Locking method**

i14 Lock M...: mechanically locked actuator, extractable by applying voltage.

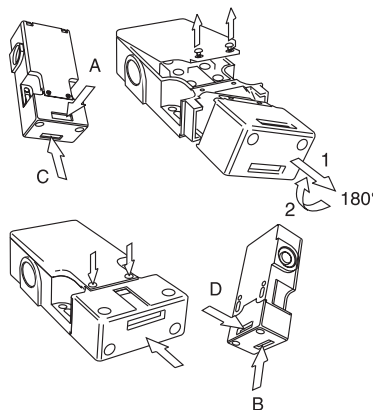

If broken, complete safety switch should be replaced

## Product selection table

Model	Solenoid release		Solenoid tension			Connector		Connection type			Part number
	mechanical	electrical	24 V DC	110 V AC	230 V AC	NO	NC	PG 13.5	SR 11	M 20	
i 14-	M		0			2	1			3	6 025 060
i 14-	M		0			3	0			3	6 025 062
i 14-	M			1		2	1			3	6 025 064
i 14-	M			1		3	0			3	6 025 066
i 14-	M				2	2	1			3	6 025 068
i 14-	M				2	3	0			3	6 025 070

We recommend contacting Customer Service for product selection.

## Accessories

Straight actuator with additional retention device and head cover iE 14-S1

Part number 5 311 133

